

QUICK **surface**

The modern 3D Reverse engineering software

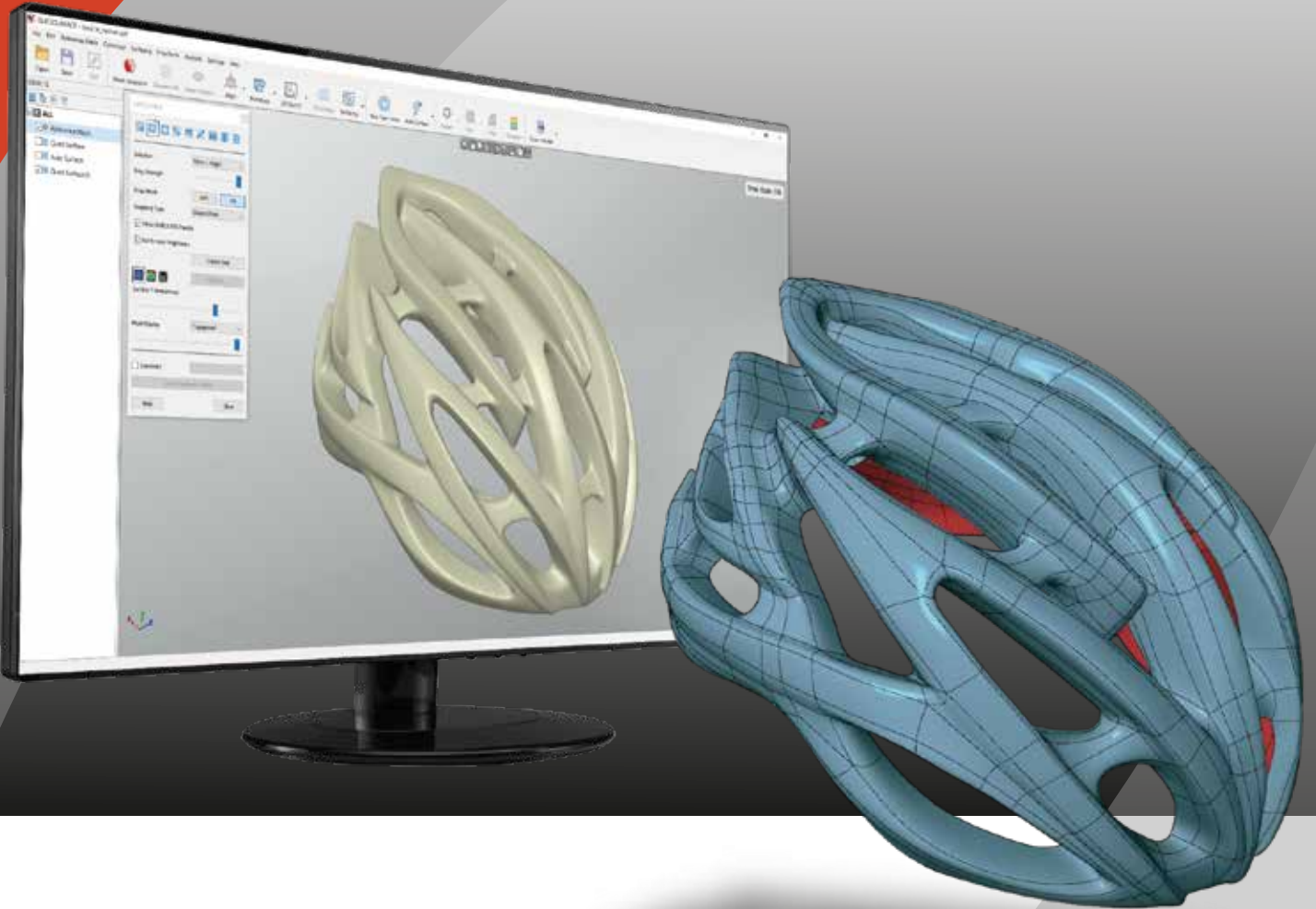

**The bridge between
3D scanning and Manufacturing!**

www.quicksurface3d.com

HOW IT WORKS?

QUICKSURFACE is a complete 3D reverse engineering solution that compliments to any 3D scanner which can export STL mesh data or PTX point clouds. Working with a large meshes **QUICKSURFACE** provides all necessary tools to convert the meshes into editable CAD models. Interactive tools for hybrid parametric modelling of both organic and prismatic shapes that fit the meshes. Export data in standard IGES or STEP file formats or build fully parametric history tree directly into other **CAD/CAM** packages or use your results for **3D printing** or **CNC machining**.

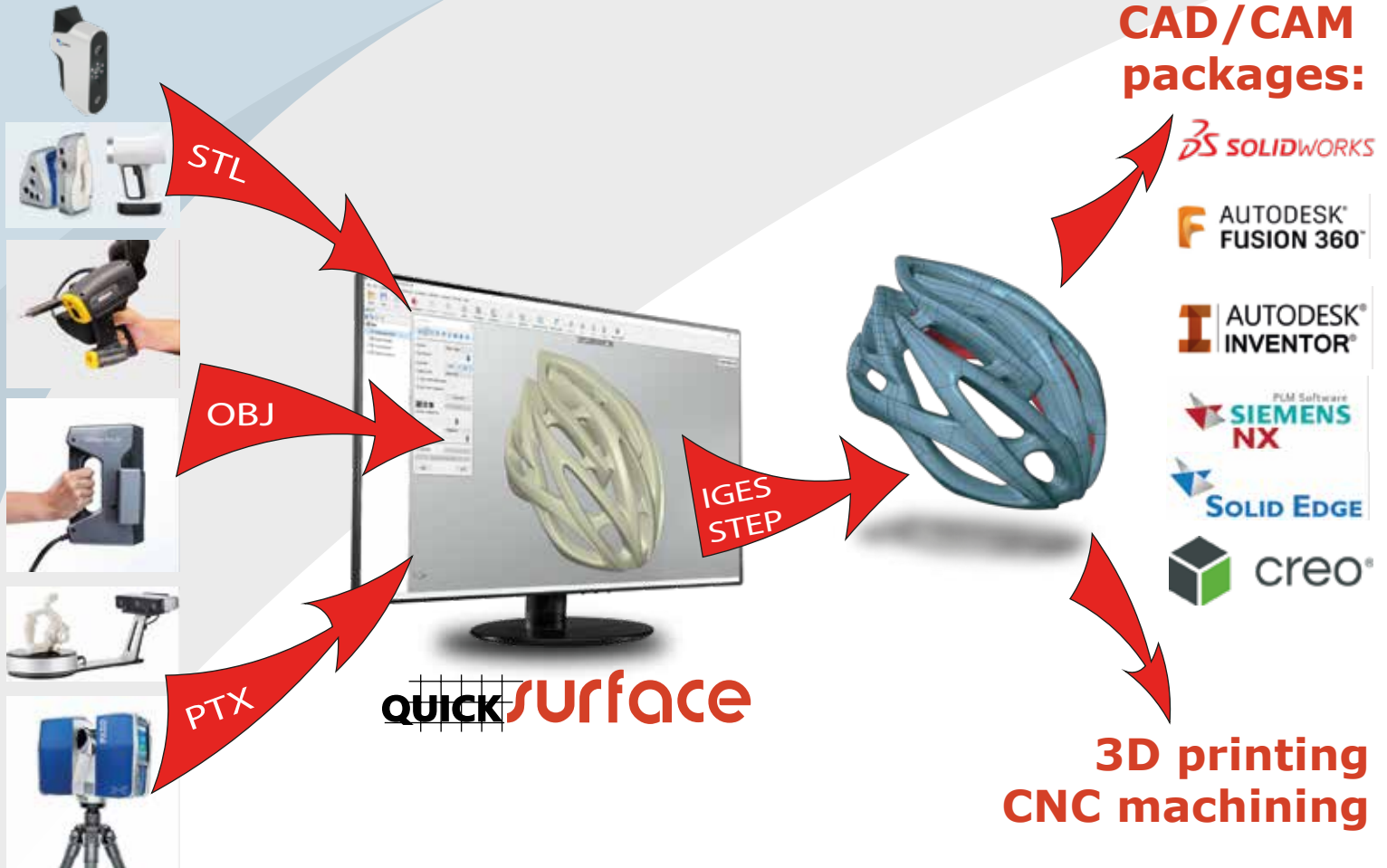

From 3D scan to CAD

3D Reverse engineering and remodelling can be complex, tedious and time-consuming job. Use **QUICKSURFACE's** simple & powerful tools to remodel your object with the best accuracy and design intent.

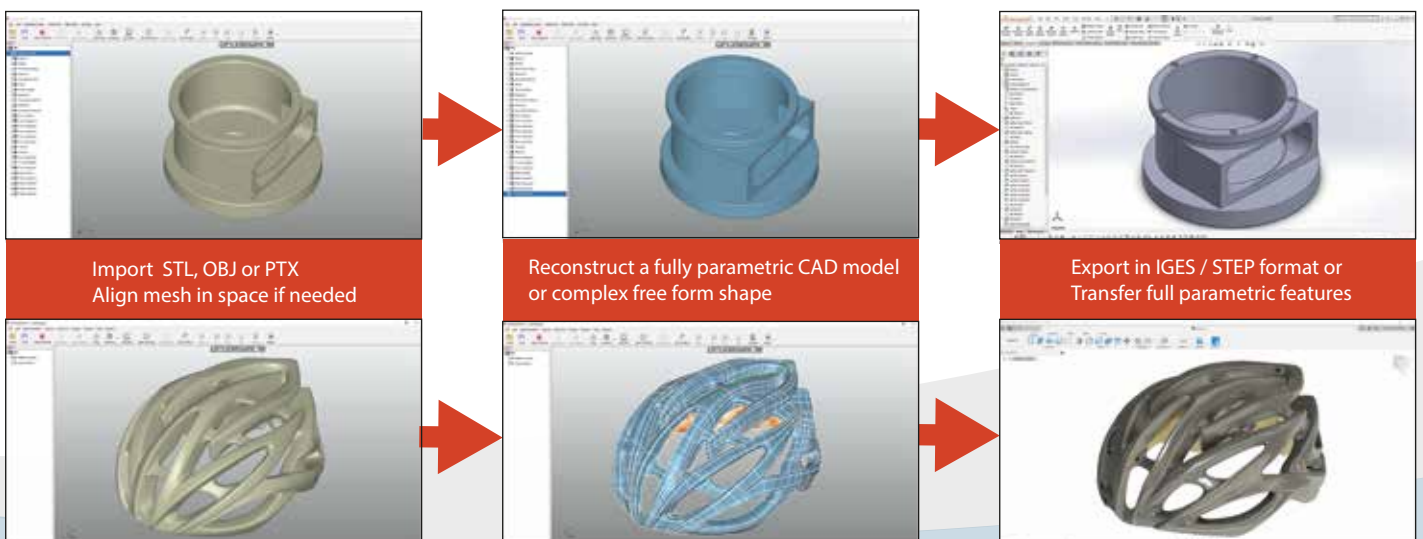

Why do you need quicksurface?

QUICKSURFACE is a 3D modelling software for Reverse engineering mechanical or free form physical objects into professional CAD/CAM models. It is created for engineers, who want access to 3D modelling, but do not have the time to learn complex traditional CAD systems.

- Prepare models for manufacturing
- Speed up your time for manufacturing
- Reduce costs for design
- Edit and repair CAD data for broken tools and moulds
- Increase design capabilities
- Use existing assets to reverse engineer new parts
- Design bespoke products
- Export remodelled data for 3D printing
- Transform physical parts into CAD for new designs
- Create new parts to fit with existing parts
- Simplify models for simulation
- Packaging Design

SIMPLE
POWERFUL
AFFORDABLE

APPLICATIONS

Industrial Design and Manufacturing

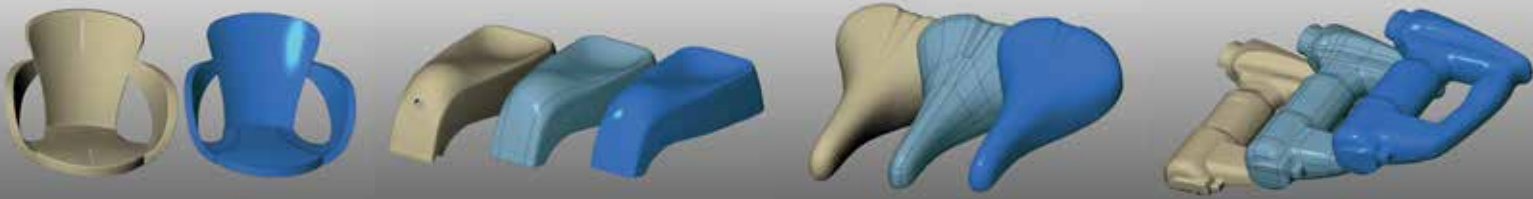

Automotive, Aerospace & Mechanical Parts

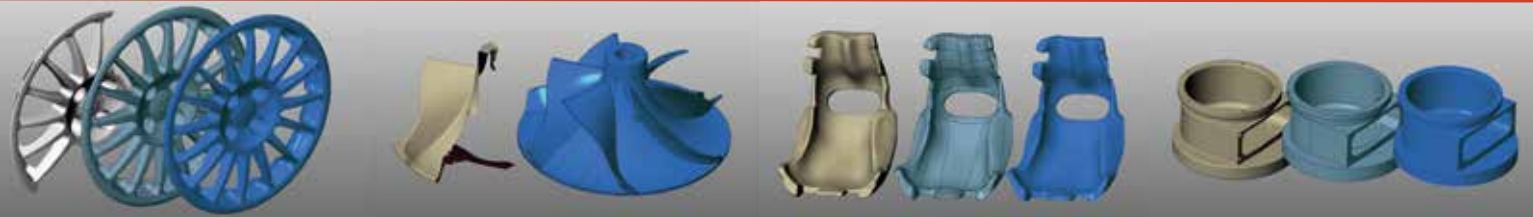

Healthcare



Fashion, Jewellery, Animation & Toys



FEATURES:

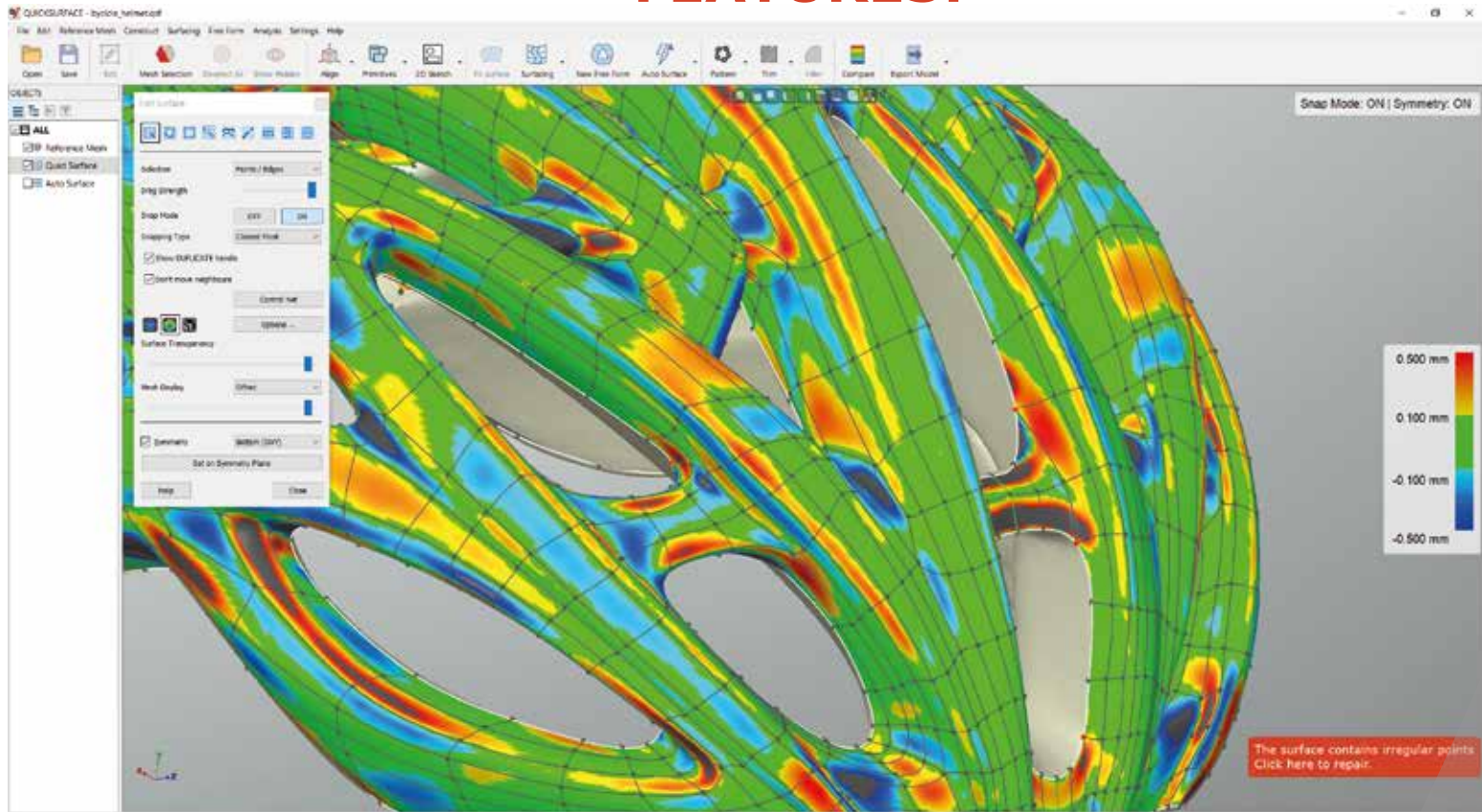

- Working with Large Meshes
- Mesh editing
- User Controllable Accuracy
- Mesh Realignment
- Geometric Primitive Extraction
- Trimming & Edge filleting for solid modelling
- Parametric Modelling
- 3D Sketch on scan data
- Automatic Surfacing
- Free Form Modelling
- Real-time Deviation Control
- Hybrid Modelling – both organic & parametric shapes
- Mesh booleans with CAD features for 3D printing

QUICK **surface**
The modern 3D Reverse engineering software

CONTACTS:

United Kingdom
Cambridge
Phone: +44 793 879 90 83

Bulgaria
Sofia
Phone: +359 888 209 860

Try for **FREE** at:

www.quicksurface3d.com

E-mail: info@quicksurface3d.com